

1

2

3

4

5

REVISION TABLE

REV	ECN#	DESCRIPTION	REV BY	APPROVED	DATE
---	---	Original Drawing	SDC	MPW	1-10-18

Specifications*XY Axis*

Stroke = 0.23 in [6 mm]
 Cont. Force = 0.5 lbs [2.2 N]
 Peak Force = 1.5 lbs [4.4 N]
 Encoder = 1.0 micron

Rotary Axis

Angular Displacement = +/-5°
 Cont. Force = 2.20 in-lbs [0.25 Nm]
 Peak Force = 6.50 in-lbs [0.73 Nm]
 Encoder = 239,389 cnts/rev

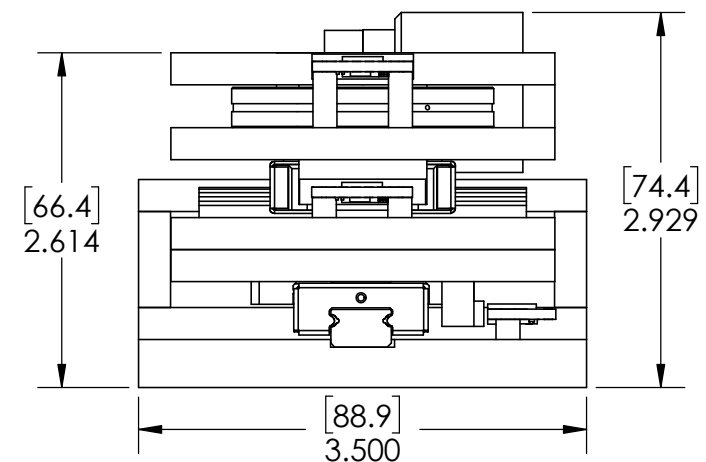
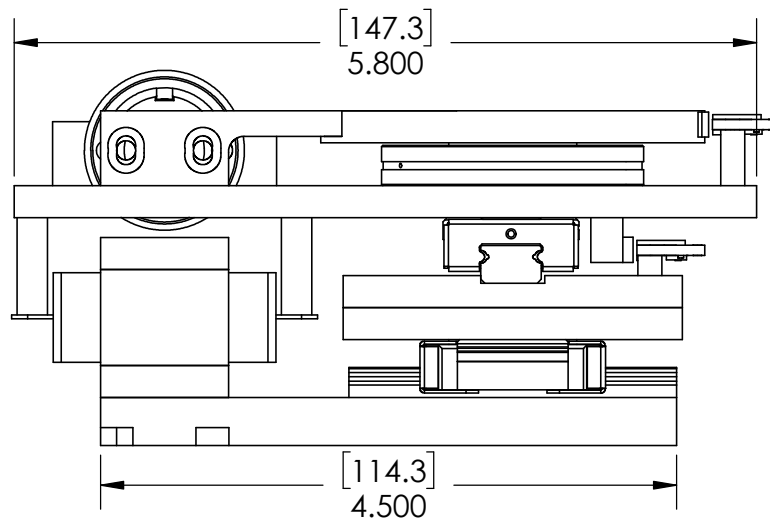
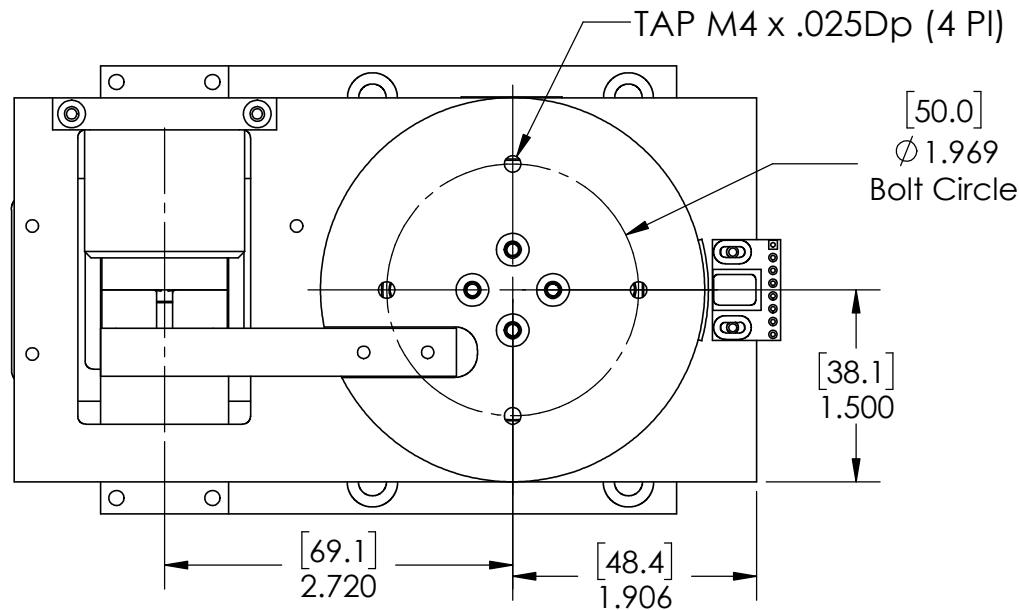

H2W Technologies, Inc.

Santa Clarita, CA 91350 USA
 Tel: (661) 291-1620

www.h2wtech.com

These drawings and specifications are the property of H2W Technologies, Inc. They are issued in confidence and shall not be reproduced, copied, or used without written permission from H2W Technologies, Inc.

UNLESS SPECIFIED OTHERWISE:
 All dimensions are in inches
 Standard Tolerances are as follows
 .XXX ±.005 ANGLES ±.1°
 .XX ±.010 FILLETS .010
 .X ±.020 CORNERS .010
 Remove All Burrs and Sharp Edges

**FOR
 REFERENCE
 ONLY**

MATERIAL

FINISH

TITLE

XY Theta Voice Coil Stage

DWG #

31-0846

REV

DATE

1-10-18

SHEET

1 of 3

1

2

3

4

5

MOUNTING PROVISIONS

PARTS HAVE BEEN HIDDEN TO SHOW BASE MOUNTING HOLES

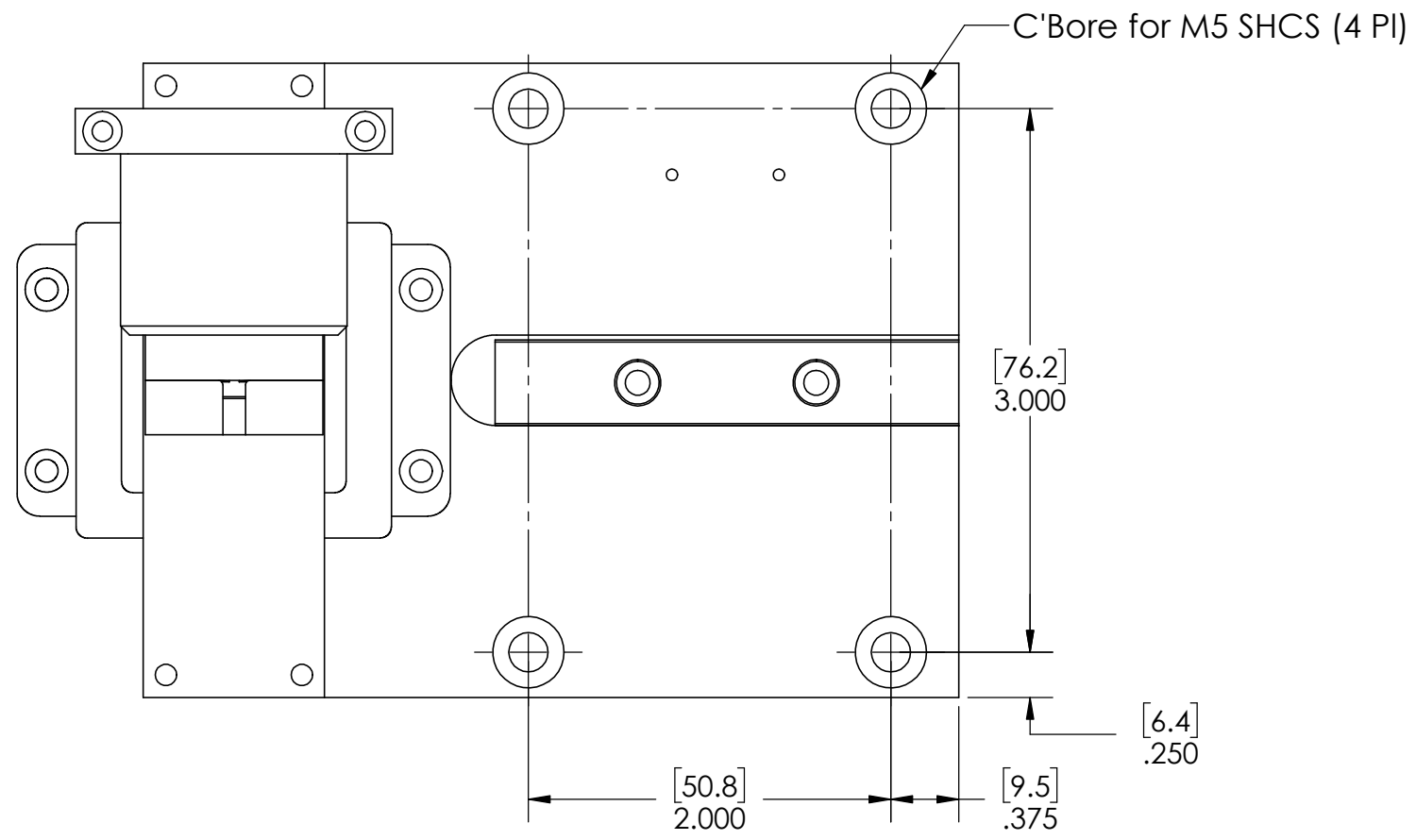

A

A

B

B

C

C

D

D



H2W Technologies, Inc.
 Santa Clarita, CA 91350 USA
 Tel: (661) 291-1620
www.h2wtech.com

These drawings and specifications are the property of H2W Technologies, Inc. They are issued in confidence and shall not be reproduced, copied, or used without written permission from H2W Technologies, Inc.

UNLESS SPECIFIED OTHERWISE:
 All dimensions are in inches
 Standard Tolerances are as follows
 .XXX ±.005 ANGLES ±.1°
 .XX ±.010 FILLETS .010
 .X ±.020 CORNERS .010
 Remove All Burrs and Sharp Edges

FOR REFERENCE ONLY

MATERIAL	
FINISH	

TITLE
XY Theta Voice Coil Stage

DWG #	31-0846
REV	----
DATE	1-10-18
SHEET	2 of 3

1

2

3

4

5

A

A

B

B

C

C

D

D

